



OAKFIELD



Eversley Road, Bexhill-On-Sea TN40 1HE

Offers Over £80,000



Eversley Road, Bexhill-On-Sea TN40 1HE

Studio apartment ideally located in the heart of Bexhill Town Centre. Just a short walk from the seafront, this bright and spacious flat offers an excellent opportunity for buyers and investors alike.

The accommodation comprises, an open-plan living/dining/bedroom area with a kitchen included in the same space, as well as a separate bathroom. The large window allows the sun to shine through.

Some work is required, giving you the perfect opportunity to add your own mark and tailor the space to your taste.

The property benefits from a new 999-year lease, with a service charge of £200 per quarter, which includes the ground rent.

Situated within walking distance to shops, restaurants, bus services, and the mainline railway station with direct links to London, this property would make an ideal home, Airbnb, or investment opportunity.

To be sold chain free with vacant possession. Early viewing is highly recommended.





Studio Room
17'5 x 12'6 (5.31m x 3.81m)

Council Tax Band- A- £1,708

Lease Information

The seller advises that the property is offered as leasehold and has approximately 999 years remaining on the lease. The service charge is £200 per quarter including ground rent. The agent has not had sight of confirmation documents and therefore the buyer is advised to obtain verification from their solicitors or surveyor.



Floor Plan

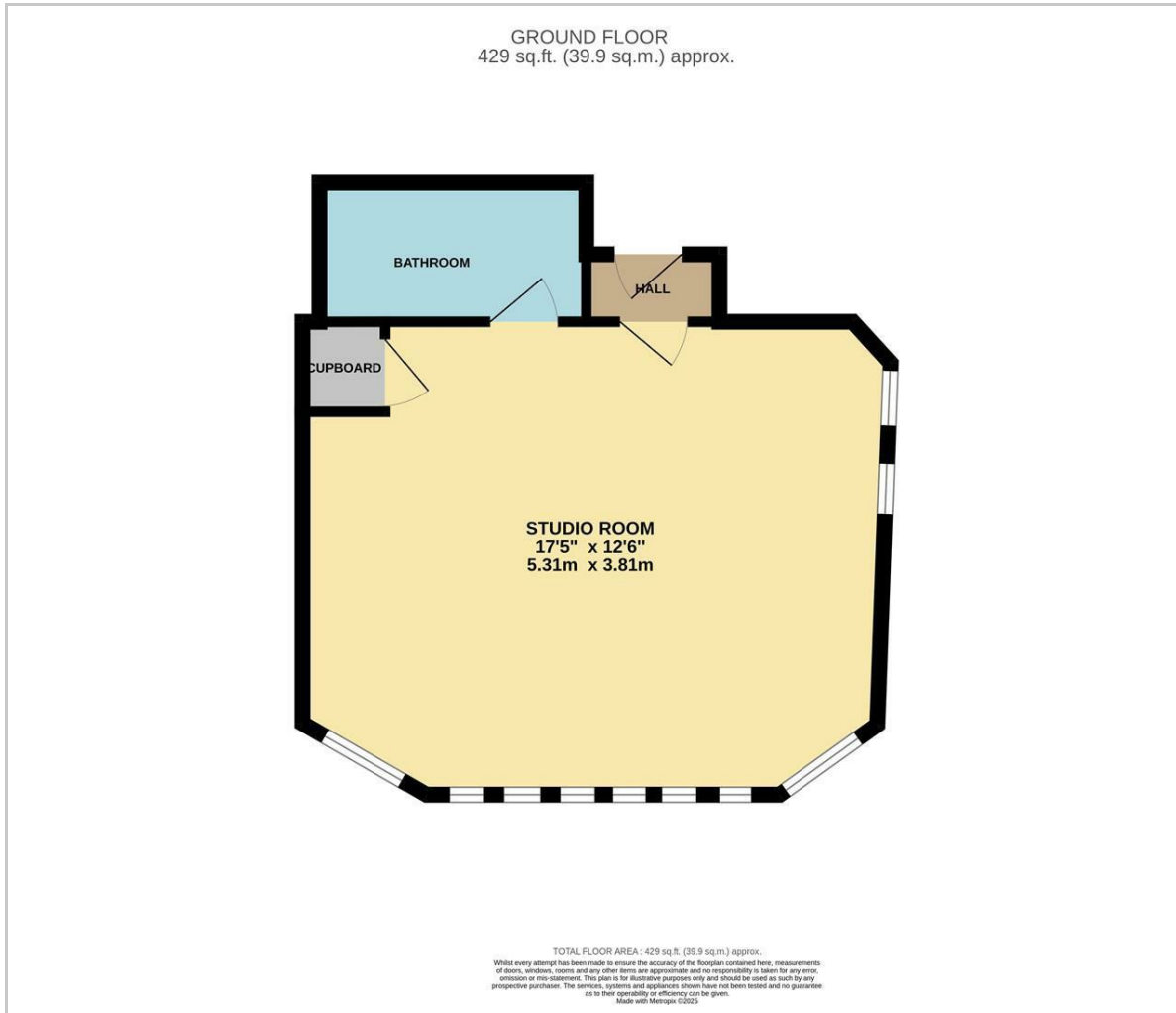

Viewing

Please contact us on 01424 224700
if you wish to arrange a viewing appointment for this property or require further information.

These particulars, whilst believed to be accurate are set out as a general outline only for guidance and do not constitute any part of an offer or contract. Intending purchasers should not rely on them as statements of representation of fact, but must satisfy themselves by inspection or otherwise as to their accuracy. No person in this firm's employment has the authority to make or give any representation or warranty in respect of the property.

12 Sackville Road, Bexhill on sea, East Sussex, TN39 3JL
Bexhill@oakfieldproperty.co.uk

Area Map

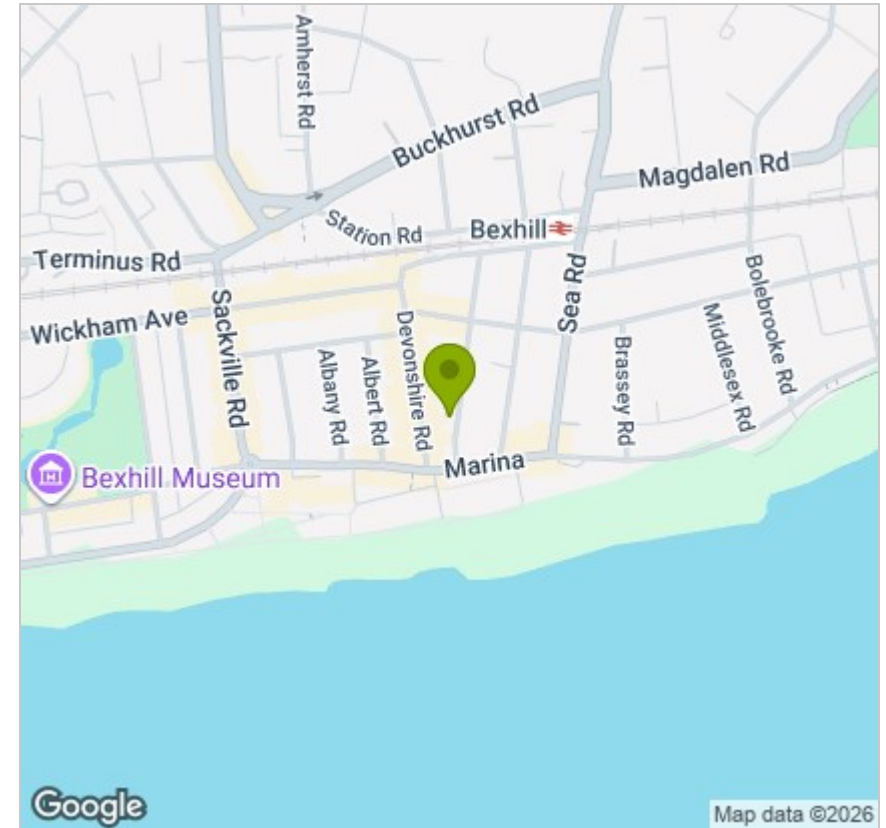

Energy Efficiency Graph

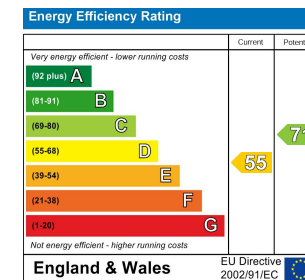

01424 224700
www.oakfieldproperty.co.uk